

# GROHE

## Exquisit 21 601

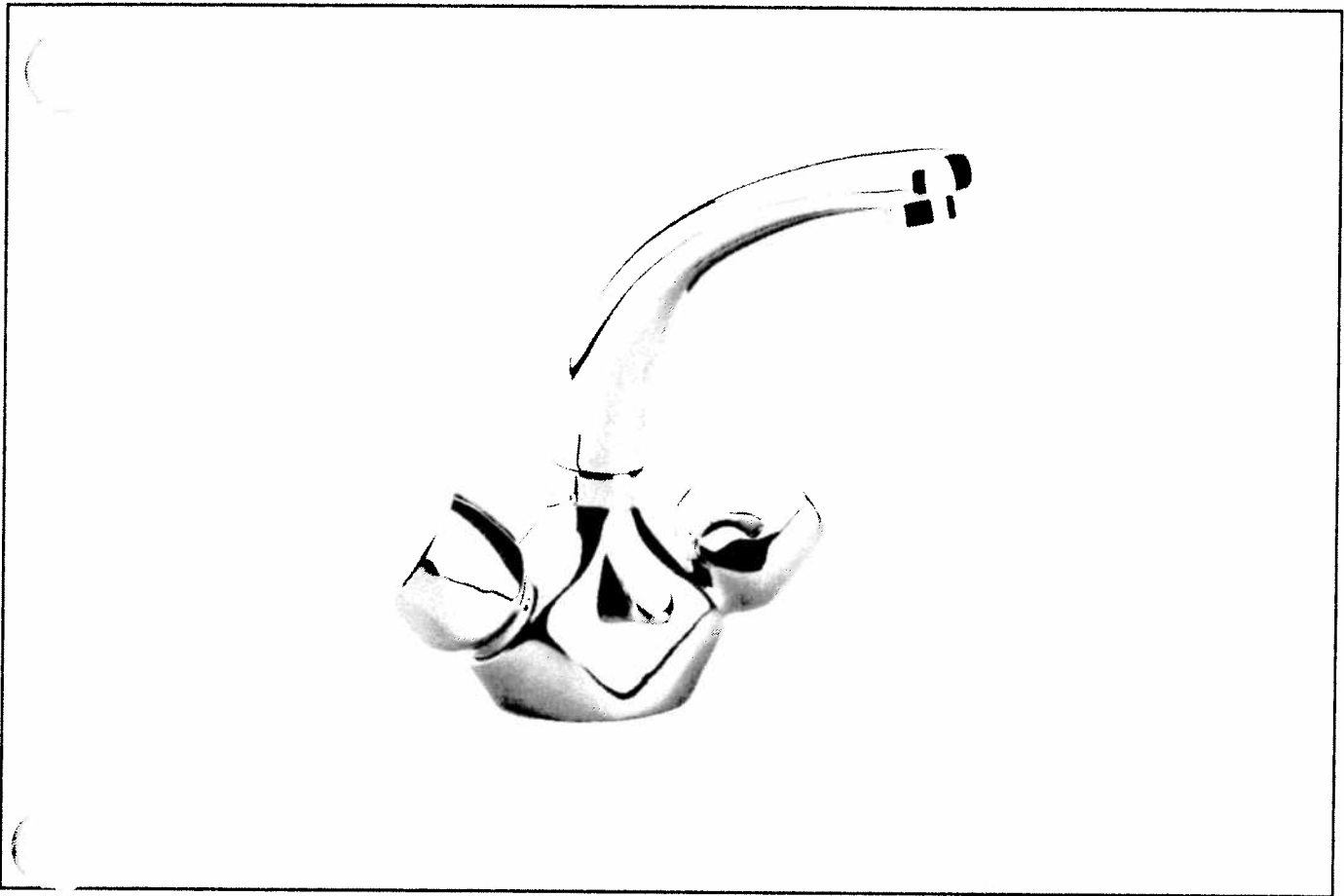

Centerset with swivel spout

Printed on chlorine-free bleached paper.  
Imprimé sur papier blanchi sans chlore.  
Impreso en papel blanqueado sin cloro.



# Installation dimensions

21 601

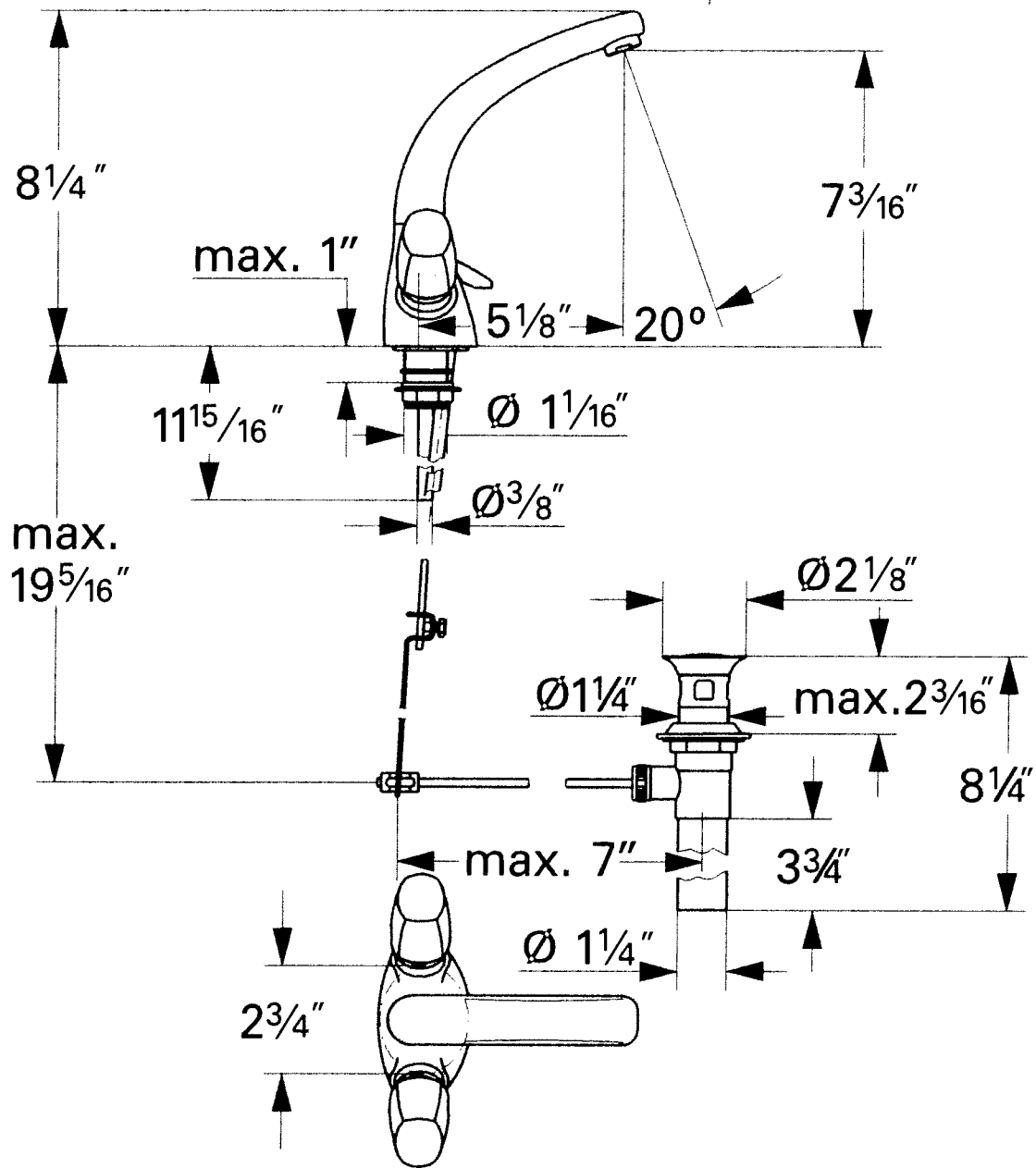

# Replacement parts

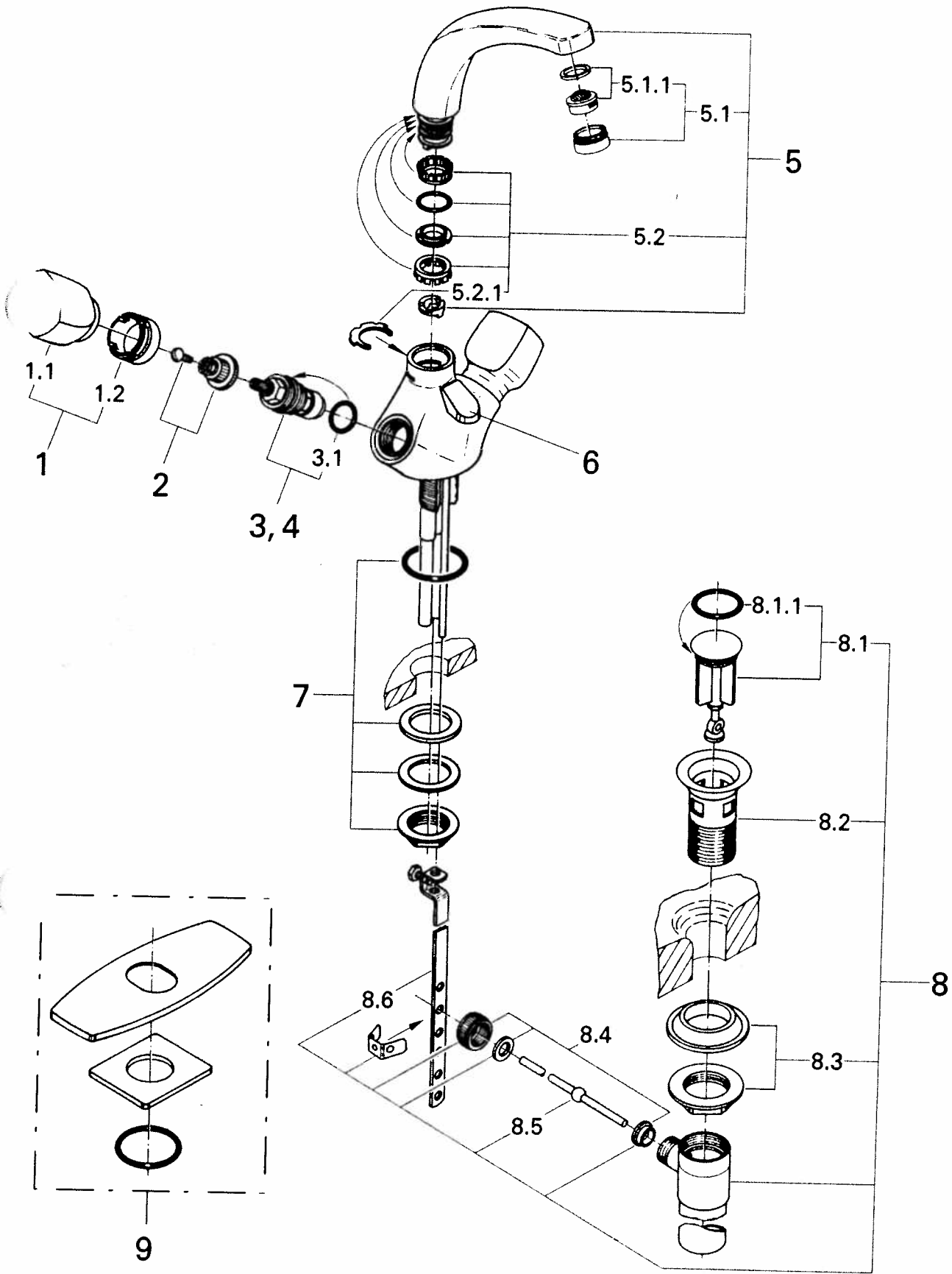

## Specification

### Application

- Pressurized storage heaters
- Thermally controlled instantaneous heaters  
(set flow temperature to 120 °F)
- Hydraulically controlled instantaneous heaters  
(operation is however subject to certain  
restrictions in comfort occasioned by the  
function of the heater)

Operation with low pressure storage heaters  
(displacement water heaters) is **not** possible.

### Specification

- Max. flow 2.2 GPM
- Flow pressure
  - min 7 p.s.i
  - recommended 15-75 p.s.i
  - greater than 75 p.s.i., fit pressure reducing  
valve
- Working pressure - max. 150 p.s.i
- Test pressure 230 p.s.i
- Temperature
  - max. (hot water inlet) 180 °F
  - recommended (economy setting) 140 °F
- Water connection hot - LH  
cold - RH

### Note

Major pressure differences between cold and hot  
water supply should be avoided.

## Replacement parts/ Care

No.	Description	Cat. No.	Pack- ing unit	No.	Description	Cat. No.	Pack- ing unit
1	Exquisit handles, pair	18 991	2	7	Mounting set	45 143	1
1.1	Exquisit handles	00 899	1	8	Pop up waste	28 958	1
1.2	Accent rings, pair	18 992	2	8.1	Stopper	45 324	1
2	Handle connection set	45 186	1	8.1.1	Stopper O-ring	01 147	5
3	Ceramic cart. 90°, right	45 625	1	8.2	Flange	01 153	1
3.1	Body seal O-ring	03 924	10	8.3	Shank nut and bushing	45 266	
4	Ceramic cart. 90°, left	45 625	1	8.4	Nut and bushings	45 265	1
5	Swivel spout	08 980	1	8.5	Ball rod	45 264	1
5.1	Flow regulator	13 955	1	8.6	Strap with screw	45 263	1
5.1.1	Flow regulator set	45 220	1				
5.2	Spout fitting set	45 474	1		Optional accessory		
5.2.1	Spout clip	05 850	10	9	6" Escutcheon	07 542	1
6	Lift rod	45 177	1				

Subject to technical modification without notice.

## Care

Instructions for care of this centerset, will be found in the Limited Warranty supplement.

Grohe America Inc.  
241 Covington Drive  
Bloomington, IL  
60108  
U.S.A.  
Technical Services  
Phone: 708/582-7711  
Fax: 708/582-7722

Grohe Canada Inc.  
862 Arvin Avenue, Unit 7  
Stoney Creek, Ontario  
Canada, L8E 5P2  
Technical Services  
Services Techniques  
Phone/Tél: 905/643-9848  
Fax/Télécopieur: 905/643-9843